



Announcing the 1993-94 Season!

The upcoming 1993-94 season promises to be one of the most ambitious we've ever produced. It's a season filled with firsts including the addition of one extra play in the fall and a longer run for the Shakespeare show in the winter.

Also new in the spring will be the world premiere of a original commissioned work by one of the country's hottest young playwrights. We'll stage two plays by contemporary female authors that we've never produced and for the musical we'll revive one of the best dance shows ever.

In the fall we'll open the season with the Central Ohio

Premiere of the swashbuckling comedy *I Hate Hamlet* by Paul Rudnick. It's about a soap opera star playing Hamlet in Central Park who gets coaching from the ghost of John Barrymore. This will be followed by *Top Girls*, a serious comedy about women and work, by the provocative and unconventional British playwright Caryl Churchill. A charming musical version of A. A. Milne's *Winnie-the-Pooh* will be presented in November (a non-subscription show) and it promises to enchant audiences of all ages.

In the fall we'll open the season with the Central Ohio comedy about modern life and

modern art, opens in January, and in March, we'll present one of Shakespeare's greatest tragedies, *King Lear*. Theatre faculty member Ed Vaughan will assume the title role in this macabre melodrama of filial ingratitude.

Pippin is this year's spring musical. It's the story of a young man's rocky road to wisdom and maturity and marks a return to a heavy dance musical much like *A Chorus Line*. It features a tremendously appealing score by *Godspell* composer and lyricist Stephen Schwartz. The season closes with a world premiere from playwright Anthony Clavoe based

▼ "One of the year's best musicals." *Big River* featured Tony award-winner Ron Richardson as Jim opposite Carey Moore's Huck Finn. "Guest Equity performer Ron Richardson ... brings a bona fide Broadway pizzazz to the college show." "Acting is superb. So is the singing..." —Michael Grossberg, *The Columbus Dispatch*.

on Dostoevsky's classic tale of murder and lust, *The Brothers Karamozov*. This one's so new we haven't even read the script!

So there you have it—a thumbnail sketch of what promises to be an adventurous ride for all. Please don't delay. Order season tickets today and join us for an exciting year of firsts. This will be a memorable season filled with laughter, music, drama and romance you won't want to miss. ▼



OTTERBEIN
COLLEGE

Otterbein College
Department of Theatre & Dance
Westerville, OH 43081-2006

Non-Profit Org.
US Postage
PAID
Westerville, OH
Permit 177

If you receive more than one copy of this newsletter, please pass one along to a friend.

The Musical

Lyrics by A.A. Milne
Music by Allan Jay Friedman
Adapted by Kristin Sergel
Directed by Pamela Hill
Musical Direction by Michael Haberkorn

November 19 at 7:30 p.m.
November 20 at 10:30 a.m. and 1:30 p.m.
November 21 at 1:30 p.m.
Cowan Hall

A.A. Milne's poetry provided the basis for most of the lyrics for this enchanting musical tale for youths of all ages. Winnie-the-Pooh is Christopher Robin's far little bear of Very Little Brain, who would like to drift peacefully through life. However, he finds himself involved in all sorts of frantic adventures, assisted by such friends as the dismal Eeyore, Piglet and Rabbit, with his countless relations. Pooh's intentions are always the best, but his passion for honey and condensed milk keeps getting him in trouble. A. A. Milne's wit and special understanding of young people make this a must-see for the entire family!

Bonus! Purchase season tickets today and order tickets for *Winnie-the-Pooh* at a special discounted rate. Regular general admission ticket price is \$4.50. ▼

(Special elementary school matinees Nov. 17 and 18—teachers should contact Otterbein College Theatre directly at 614/823-1209 for information and reservations.)



funny, provocative comedy from one of the most inventive British playwrights of her generation and author of *Mad Forest*, *Cloud Nine*, *Fen* and *Serious Money*. *Top Girls* is the name of a London employment agency that coaches its female clients into adopting male business-world traits and values. Marlene, the smart, ruthless, head of the agency, and the play's main character, is efficient as a computer and about as warm-hearted. She's the embodiment of corporate success—and she has no time for losers. But among the baggage Marlene has left behind is Angie, the illegitimate daughter she dumped on her sister 16 years before. "a blistering yet sympathetic look at women who achieve success by adopting the worse traits of self-made men...a truly original theatrical mind at work."—*N.Y. Times*. ▼

Museum

by Tina Howe
Guest Directed by Rich Cole

January 26, 27, 28, 29, 30,
February 2, 3, 4, 5, 6
Wed.-Sun. each week
Campus Center

From the award-winning author of *The Art of Dining*, *Painting Churches*, *Coastal Disturbances*, and *Approaching Zanzibar*, comes a wry, satirical comedy about modern art and modern life. *Museum* takes place on the final day of a group show (entitled "The Broken Silence") of three fictitious contemporary American artists being exhibited in a major museum of modern art. In the course of the day some forty people walk through the show; art lovers, skeptics, foreigners, students, lost souls, fellow artists, and of course, museum guards. The play is about the movement and yearning of these people "...moving and beautiful... a passionate and thoroughly personal play about the whole world..."—*Village Voice*. "...excellent 'slice of life comedy'...exceptionally good comment on the human condition."—*Variety*. ▼



▼ From the last season's *The Royal Family*, loosely based on the life of the Barrymores, "Otterbein's handsomely mounted revival puts a breezy polish on George Kaufman and Edna Ferber's classic offstage comedy..."
—Michael Grossberg, *The Columbus Dispatch*.

William Shakespeare's

Directed by Christina Kirk
with Equity Actor Ed
Vaughan as "Lear"

King Lear

March 3, 4, 5, 6;
10, 11, 12
Thurs.-Sun.,
Thurs.-Sat.

(High School Matinee Performance is Wednesday,
March 2 at 10:00 am)
Cowan Hall

One of Shakespeare's most gripping and powerful tragedies, it ranks with *Hamlet*, *Macbeth* and *Othello* as one of the truly great masterpieces of world drama. A somber, stormy play about filial ingratitude, *Lear* is full of murder, madness, treachery, hatred, lust and greed. Described by the Bard himself as "The most piteous tale that ever ear received," this is a story about a foolish old man humiliated and turned bitter by two scheming daughters. The parallel subplot about the Earl of Gloucester also tells of a man who misjudged his siblings and paid dearly for it. Like all great tragedies, the story of *Lear* and his folly purges the emotions by terror and pity. This is lyric poetry and epic drama that must be experienced! ▼



▼ The wedding pose from *The Marriage of Bette and Boo*, "a deft, ditzzy, dark serio-comedy..." —Michael Grossberg, *The Columbus Dispatch*.

▼ From last season's *All My Sons*, "Otterbein revival of 1947 'Sons' sparkles with intensity and clarity." "Superior student cast proves that Miller's drama is still powerful." —Michael Grossberg, *The Columbus Dispatch*.



Directed by Dennis Romer
Musical Direction by David DeVenney,
Choreography by Stella Kane
Co-sponsored by the Department of Music

April 28, 29, 30, May 1; May 5, 6, 7
Thurs.-Sun., Thurs.-Sat.
(High School Matinee is Wednesday,
April 27 at 10:00 am)
Cowan Hall

What is a young man to do when his father is Charlemagne, the Holy Roman Emperor? That's the basic premise for this wildly magical and innovative musical extravaganza that ran for over four and a half years on Broadway in the 70's. With a dazzling score by *Godspell* composer and lyricist Stephen Schwartz, *Pippin* is the fictional story of one young man's journey to maturity. He tries war, sex, revolution and marriage. All to no avail. Part circus, ballet, musical comedy, rock concert, spectacle and vaudeville, *Pippin* is an 8th century quest for fulfillment—a search for one's "corner of the sky." A colorful, musical parable, *Pippin* is a proven crowd-pleaser featuring such memorable tunes as "Magic To Do," "No Time At All," and "Spread A Little Sunshine." Don't miss this delightful musical romp—it promises to be the highlight of the year! ▼



**BOX
OFFICE**
823-1109

The box office, located in the lobby of Cowan Hall, is open from 1:00 to 4:30 p.m. weekdays. It is also open one hour prior to all scheduled performances. Mail orders (for individual

**WHY
SUBSCRIBE?**

▼ **The Best Seats at the Best Price**

Subscribers are guaranteed the "best seats in the house" at the best possible price. This season you'll see six shows for the price of five!

▼ **Convenient Ticket Exchange**
This is an exclusive benefit for subscribers only. All individual

Season Ticket Tips

We've devised a list of suggestions to help you in ordering your season tickets. While we can't make any guarantees, following these steps should insure that you get the best possible seating.

▼ Send your order as soon as possible. This is the best way to get good seats. We receive 75% of our orders within three weeks of this mailing so don't delay.

▼ Fill out the order form completely. Be sure to read the instructions carefully, circle all your dates and enclose payment for the proper amount.

▼ Don't be afraid to write us a note. If there is something about your seating you like or dislike, or if you wish to be seated with a friend, let us know. Please be specific.

▼ Choose your night and be consistent. To make it easier to seat you, please pick a 1st Saturday or 2nd Wednesday or 1st Sunday, etc.. Shifting nights and weeks causes great difficulty. Remember, you can always exchange your tickets at a later date.

▼ If you have questions about the order form, call 823-1209.

Experience London

December 7-20, 1993

We are pleased to invite our theatre patrons to the annual LONDON THEATRE TOUR, fully escorted by Dean Joanne VanSant and Dr. Marilyn Day, who have been hosting London theatre tours for years. The tour is a 13 day/12 night trip to England including airfare and hotel accommodations staying in:

Stratford-on-Avon

- 3 nights with bed and full breakfast accommodations. A tour and performance at The Royal Shakespeare Theatre, visits to Anne Hathaway's cottage, Shakespeare's birthplace, and a day trip to Coventry Cathedral and Warwick Castle.

London

- 9 nights in London at the President Hotel with private bath and continental breakfast.
- 3 theatre tickets
- A half-day sightseeing tour
- Transportation pass for bus and underground travel
- Escorted visits to British Museum, antique markets, Wesley's Chapel, Speaker's Corner, the Tower of London, the National Theatre and Windsor via British Rail (optional)
- A tour of parliament
- A half-day escorted tour of Oxford, the city and a college
- A full-day coach trip to Canterbury and the cathedral, Dover Castle and the White Cliffs
- A program especially designed for nurses is available. Please call for details.

Cost is approximately \$1,745.00 per person. Single supplement is \$190.00. A \$250.00 non-refundable deposit is due by September 24, 1993. For information and/or reservations, call 614/823-1305 or 823-1400.▼

Easy to Reach



Free Parking

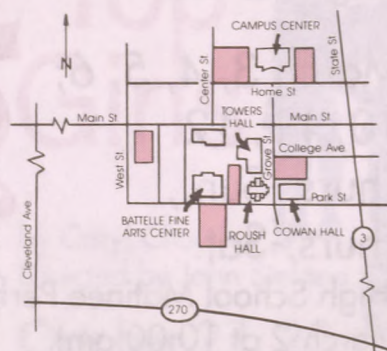

▼ "If it's a nifty farce, this must be Otterbein College Theatre. If it's an especially lively farce, the director must be Ed Vaughan." —Michael Grossberg, *The Columbus Dispatch*. A climactic moment from last year's wildly amusing *Lend Me a Tenor*.

----- Cut here and mail to Otterbein College Theatre, Westerville, Ohio 43081 -----

1993-94 Season Ticket Order Form

Individual Ticket Prices See Six Shows for the Price of Five!

	Option #1 Fri/Sat	Option #2 W/Th/Sun.	Option #3 Opening Nite
<i>I Hate Hamlet</i>	\$9.50	\$8.00	\$8.00
<i>Top Girls</i>	\$9.50	\$8.00	\$8.00
<i>Museum</i>	\$9.50	\$8.00	\$8.00
<i>King Lear</i>	\$9.50	\$8.00	\$8.00
<i>Pippin</i>	\$12.50	\$10.50	\$10.50
<i>New Play</i>	\$9.50	\$8.00	\$8.00

Single Ticket Total \$60.00 \$50.50 \$50.50

Season Ticket Cost **\$50.00** **\$40.00** **\$36.00**
(Save 17%) (Save 22%) (Save 29%)

I Hate Hamlet, *Winnie-the-Pooh*, *King Lear* and *Pippin* will be performed in Cowan Hall. *Top Girls*, *Museum* and the *New Play* will be performed in the Campus Center Theatre.

Season Ticket Availability Dates

Please circle desired date for each play and underline your second choice in case the first is not available. **Note:** Option #3, Opening Nite Club, must circle the 1st Wednesday for each play and the 1st Thursday for *King Lear* and *Pippin*. 1st Thursday subscribers must choose the 2nd Thursday for *King Lear* and *Pippin*.

	Wed.	Thurs.	Fri.	Sat.	Sun./Mat.
<i>I HATE HAMLET</i>	6	7	8	9	10
October		14	15	16	
<i>TOP GIRLS</i>	27	28	29	30	
Oct./Nov.	3	4	5	6	7
<i>MUSEUM</i>	26	27	28	29	30
Jan./Feb.	2	3	4	5	6
<i>KING LEAR</i>		3	4	5	6
March		10	11	12	
<i>PIPPIN</i>		28	29	30	1
April/May		5	6	7	
<i>NEW PLAY</i>	25	26	27	28	29
May/June	1	2	3	4	5

Winnie-the-Pooh (As a bonus to subscribers, you may order your general admission tickets to *Winnie-the-Pooh* along with your season tickets at \$1.00 off the normal price.)

Please circle your desired performance below:

Fri. 11/19 7:30 p.m.	Sat. 11/20 10:30 a.m.	Sat. 11/20 1:30 p.m.	Sun. 11/21 1:30 p.m.
-------------------------	--------------------------	-------------------------	-------------------------

I wish to order _____ Option #1 season tickets at \$50.00 each (save 17%) \$ _____
I wish to order _____ Option #2 season tickets at \$40.00 each (save 22%) \$ _____
I wish to order _____ Option #3 season tickets at \$36.00 each (save 29%) \$ _____
I wish to order _____ *Winnie-the-Pooh* tickets (optional) at \$3.50 each \$ _____

Enclose \$1.50 for Postage/Handling \$ 1.50

Please consider a tax-deductible contribution—any amount would be appreciated. \$ _____

Total Enclosed \$ _____

Make checks payable to Otterbein College Theatre or charge to:

MasterCard # _____ or Visa # _____ Exp. Date _____

Name _____ Signature (for charge card) _____

Street _____ City _____ State _____ Zip Code _____

Phone (home) _____ (work) _____ ☐ I am a new subscriber ☐ I was a subscriber last year

All sales are final--ticket requests will be filled in the order they arrive at the box office.

Your tickets will be mailed to you the week of September 20, 1993.