

# Stages

FALL 1992 ▼ VOLUME III, NUMBER 4

OTTERBEIN COLLEGE DEPARTMENT OF THEATRE & DANCE

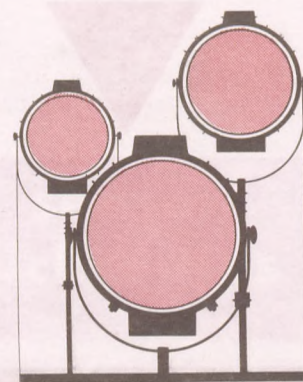

## Get set for variety!

### Announcing the 1992-93 season

Topping last year's season is an enormous challenge. Almost every show set new attendance records and earned high praise from the critics. *Rumors* was tremendously funny as was *Nunsense*—both set new all-time highs. *The Tempest* was as beautiful and opulent as *Talking With...* was simple and poignant. And the highlight of last year was *Into The Woods* which was recognized by *Dispatch* critic Michael Grossberg as the best musical of the season and Dennis Romer was singled out for his work as best director of a musical.

Okay, so what to do this year? Hopefully, more of the same. We'll open the year with the ridiculously silly farce *Lend Me a Tenor*. We'll follow that with the American dramatic classic *All My Sons* from

Pulitzer-Prize winner Arthur Miller. *The Royal Family* is up next—it's a stylish comedy that sends-up a fictitious "first family" of the theatre. This year's musical offering is the 1985 Tony Award winner *Big River*. As you know, musicals are a special strength of ours (*A Chorus Line*, *Sweeney Todd*, *Evita*, *Man of La Mancha* and *Into The Woods* have all been named among the top ten productions in Columbus by the *Dispatch*) and we promise another lavish springtime production. Finally we close the season with



▼ From last season's record-breaking *Into The Woods*—"Otterbein College's theatre and music departments meet the show's enormous challenges in a big, broad, satisfying production. It is hard to know where to start flinging bouquets."—Frank Gabrenya, *The Columbus Dispatch*.

Christopher Durang's *The Marriage of Bette and Boo*—a biting, satirical look at two very odd Catholic families.

So—we certainly think this season has plenty to offer everyone.

Please don't delay. Order season tickets and join us for what promises to be another entertaining, uplifting year of laughter, music, and romance. ▼

**OTTERBEIN**  
COLLEGE

Otterbein College  
Department of Theatre & Dance  
Westerville, OH 43081-2006

Non-Profit Org.  
US Postage  
PAID  
Westerville, OH  
Permit 177

*If you receive more than one copy of this newsletter, please pass one along to a friend.*





# Now that's entert

## why subscribe?

**The Best Seats at the Best Price**  
Subscribers are guaranteed the "best seats in the house" at the best possible price. This season you'll see five shows for the price of four!

**Convenient Ticket Exchange**  
This is an exclusive benefit for subscribers only! All individual tickets sales are final and may not be exchanged.

**Discount Coupons**  
Along with your season tickets, you'll receive our "Bring-a-Friend" coupons and discount coupons for Opus Zero, Otterbein's singing and dancing ensemble.

**Special Children's Show Bonus**  
As a subscriber we'll allow you to order discount tickets in advance to our annual children's theatre production.

**A Free Subscription to STAGES**  
Published quarterly, *Stages* features news and notes of Otterbein College Theatre.



▼ Last year's *Nunsense* played to 100 percent capacity and earned much critical praise—"This nice student show holds its own against previous local productions . . ." —Michael Grossberg, *The Columbus Dispatch*.

### Outrageous Farce **Lend Me A Tenor**

by Ken Ludwig

October 7, 8, 9, 10, 11;  
15, 16, 17

**Wed.-Sun. Matinee;  
Thurs.-Sat.**

(High School Matinee  
Performance is Tues.,  
October 6 at 10 a.m.)

Directed by Ed Vaughan

This is the biggest night in the history of the Cleveland Grand Opera Company, for this night in September, 1934, world-famous tenor Tito Morelli (also known as "Il Stupendo") is to perform his greatest role ("Otello") at the gala season-opening benefit performance. Through a wonderfully hilarious series of mishaps, "Il Stupendo" is drugged and thought to be dead. What to do? Not to worry, Max, a "gofer" and aspiring singer, will assume the role. However, Morelli is not dead and the comic sparks really fly when we find two Otellos running around and two women running around, each thinking she is with "Il Stupendo." A sensation on Broadway, where it earned seven Tony nominations, and in London's West End, *Lend Me A Tenor* is "A free-flowing, honest-to-goodness farce." —*N.Y. Magazine*. ▼

### Compelling Drama **All My Sons**

by Arthur Miller

January 27, 28, 29, 30,  
31; February 3, 4, 5,  
6, 7

**Wed.-Sun. Matinee,  
each week**

Directed by Dennis Romer

Written by Pulitzer Prize-winner Arthur Miller, this 1947 drama earned the N. Y. Critics Circle Award during its original run on Broadway. Numerous successful productions have followed and in 1987 it earned a Tony for Best Revival as well as the Outer Critics Circle Award. Universally-acclaimed and set against the backdrop of World War II America, *All My Sons* is the story of a father who is taught a tragic lesson in human responsibility when his pilot son is killed as the result of a defect in engine parts the father sold to the Army, while knowing the parts were imperfect. Just as timely and relevant today in a society where greed and moral corruption abound, this play is "a drama of force and passion." —*N.Y. Post*. ▼



▼ "Sinuous choreography, stunning costumes and elaborate special effects..." were among the highlights of 1991-92's *The Tempest*.

### Hilarious Comedy **The Royal Family**

by George S. Kaufman and  
Edna Ferber

March 10, 11, 12, 13, 14

**Wed.-Sun. Matinee**

(High School Matinee  
Performance is Tues.,  
March 9 at 10 a.m.)

Directed by Christina Kirk

Written in 1927 and successfully revived in 1951 and 1975, *The Royal Family* is a nostalgic and sentimental account of Broadway in its infancy. Dipping freely into the fabled lives of two of the stage's most fabled families—the Barrymores and the Drews—the play tells the often tender and hilarious story of the Cavendishes, an old and celebrated "First Family" of the theatre. Ruled by the stern matriarch, Fanny, the doughty Cavendish clan is composed of her brother Herbert Dean, once a distinguished actor; his perpetual ingenue wife, Kitty; the ancient Fanny's daughter, Julia, the number-one leading lady of the time; Julia's daughter, the revolting Gwen; and Anthony, who has "gone Hollywood." An affectionate spoof, *The Royal Family* is a comedy of great style and flourish. ▼

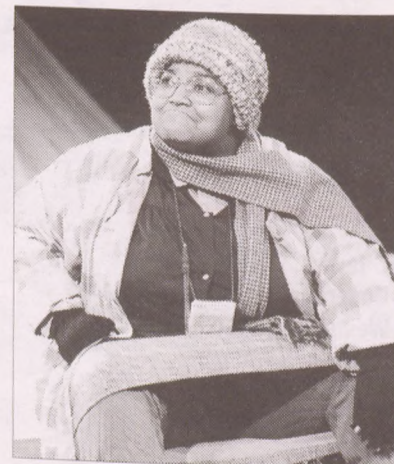

▼ "All 11 student actresses turn in personality-filled performances under Ed Vaughan's direction"—Michael Grossberg, *The Columbus Dispatch*, on last season's *Talking With* . . .



# ainment . . .

## Best Musical of the Year **Big River** *The Adventures of Huckleberry Finn*

Music and Lyrics by  
Roger Miller  
Book by William Hauptman  
Adapted from the novel by  
Mark Twain  
Co-Sponsored by the  
Department of Music  
Directed by John Stefano  
Featuring Equity Guest  
Artist TBA

April 29, 30, May 1, 2;  
6, 7, 8

**Thurs.-Sun. Matinee;**  
**Thurs-Sat.**

(High School Matinee  
Performance is Wed.,  
April 28 at 10 a.m.)

Winner of seven Tony Awards, including Best Musical, Outstanding Original Score, and Outstanding Book of a Musical, this 1985 musical is "a rousing, high-spirited show that sets your hands to clapping, your feet to stomping and your heart to rise within you."—*WCBS-TV*. Based on the Mark Twain classic, *Big River* features an enormously appealing country-bluegrass-gospel score written by King of the Road Roger Miller. Melodic and tuneful with a homespun appeal, the songs range from the upbeat "Muddy Water" to the twangy, heart-rending ballads "You Ought to Be Here With Me," "Leaving's Not the Only Way to Go" and the poignant "World's Apart" and "Free at Last." "From the moment the lights go down, your heart leaps up as you feel enveloped by the ambience and atmosphere of *Big River*."—*N.Y. Magazine*. ▼

## Biting Satire **The Marriage of Bette and Boo**

by Christopher Durang

May 26, 27, 28, 29,  
30; June 2, 3, 4, 5, 6  
**Wed.-Sun. Matinee,**  
**each week**

Director TBA

Winner of the coveted Obie Award, *The Marriage of Bette and Boo* is a brilliant and funny dissection of marriage and the family in contemporary—and Catholic—America, by our theatre's master satirist. "Once more he is demonstrating his special knack for wrapping life's horrors in the primary colors of absurdist comedy."—*N.Y. Times*. The story begins with the wedding of Bette and Boo which soon is revealed as a series of catastrophes: cheerless holidays, stillbirths, family spats over Boo's drinking and his father's abusive behavior, and visits with Bette's pious, guilt-ridden sister. "*Bette and Boo* is both demented and compassionate. And wise, hysterical and incredibly sad. It is a crazy gem."—*USA Today*. ▼

Warning: This play contains  
graphic language.

**box office**  
**898-1109**

The box office, located in the lobby of Cowan Hall, is open from 1:00 to 4:30 p.m. weekdays. It is also open one hour prior to all scheduled performances. Mail orders (for individual tickets) received in advance of box office opening dates will receive priority. Box office opens for all sales on September 24 (*Lend Me A Tenor*), November 9 (*Beauty and the Beast*), January 14 (*All My Sons*), February 25 (*The Royal Family*), April 14 (*Big River*), and May 17 (*Bette and Boo*). Box office number is 614/898-1109. Individual reservations accepted with Visa/Mastercard. Season tickets will be mailed the week of September 21, 1992.

## Special! Children's Theatre **The Masque of Beauty and the Beast**

by Michael Brill

November 20, 7:30 p.m.;  
November 21, 10:30 a.m.  
and 1:30 p.m.;  
November 22, 1:30 p.m.

Directed by Sharyllynn Shaw

One of the most popular and best-loved children's tales of all time comes to life on the Otterbein Stage in November. Mixing dance, verse and magic, *The Masque of Beauty and the Beast* demonstrates the power of a pure and kind love that can transform even the simplest of beasts into the handsomest of princes. Universal in its appeal this classic story ends just as it should—with the Beauty and her Prince living happily ever after. Romantic, charming and joyful, don't miss this annual theatrical event for the entire family. ▼

**Bonus!** Purchase season tickets today and order tickets for *The Masque of Beauty and the Beast* at a special discounted rate. Regular general admission ticket price is \$4.50.

(Special elementary school matinees Nov. 18 and 19—teachers should contact Otterbein College Theatre directly at 614/898-1109 for information and reservations.)

## season ticket tips

We've devised a list of suggestions to help you in ordering your season tickets. While we can't make any guarantees, following these steps should insure that you get the best possible seating.

▼ Send your order as soon as possible. This is the best way to get good seats. We receive 75 percent of our orders within three weeks of this mailing so don't delay.

▼ Fill out the order form completely. Be sure to read the instructions carefully, circle all your dates and enclose payment for the proper amount. Failure to do so may cause delays in processing and jeopardize your seating.

▼ Don't be afraid to write us a note. If there is something about your seating you like or dislike, or if you wish to be seated with a friend, let us know. And please be specific.

▼ Choose your night and be consistent. To make it easier to seat you, please pick a 1st Saturday or 2nd Wednesday or 1st Sunday, etc. Shifting nights and weeks causes great difficulty. Remember, you can always exchange your tickets at a later date. This is our number one seating problem.



▼ A charming moment from the 1991-92 children's production of *Heidi*, an annual fun-filled event for the entire family.



## LONDON THEATRE TOUR DECEMBER 8-21, 1992

We are pleased to invite our theatre patrons to the annual LONDON THEATRE TOUR, fully escorted by Dean Joanne VanSant and Dr. Marilyn Day, who have been hosting London theatre tours for years. Tour activities include:

- ▼ Round trip air from Columbus to London
- ▼ Accommodations at Stratford Bed and Breakfast and President Hotel in London
- ▼ Tour of Anne Hathaway's Cottage and Shakespeare's birthplace
- ▼ 4 theatre tickets, including evening performance by the Royal Shakespeare Company in Stratford and 3 other plays in London
- ▼ Tour of Coventry Cathedral, Warwick Castle and Oxford
- ▼ Half-day tour of London, including Westminster Abbey and St. Paul's Cathedral
- ▼ Tour of Parliament
- ▼ Full-day trip to Canterbury and Dover
- ▼ Trips to New Caledonia Market and Porto Bello Road (antique markets)
- ▼ Visits to museums, art galleries, Bayswater Road, Speaker's Corner, and Wesley's Chapel
- ▼ Optional trips to Windsor, Stonehenge, Bath, Salisbury, Greenwich, Hampton Court Palace, and other places of interest
- ▼ Tours of the Royal Shakespeare Theatre and the National Theatre

Cost is approximately \$1,635.00 per person. Single supplement is \$180.00.  
For information and/or reservations, call 614/898-1250.

Easy to Reach

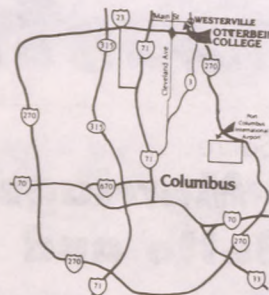

Free Parking

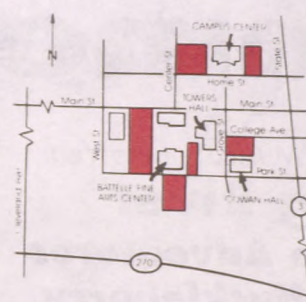

▼ The first act finale from last season's *Rumors*—" [Director] Vaughan's deft sense of pacing helps a solid student cast navigate the plot twists in Simon's two-act gagathon..."—Michael Grossberg, *The Columbus Dispatch*.

**BOX OFFICE: 898-1109**

— Cut here and mail to Otterbein College Theatre, Westerville, Ohio 43081 —

## 1992-93 Season Ticket Order Form

### Individual Ticket Prices (See Five Shows for the Price of Four!)

	Option #1 Fri-Sat	Option #2 Wed/Th/Sun	Option #3 Opening Nite
<i>Lend Me A Tenor</i>	\$9.00	\$7.50	\$7.50
<i>All My Sons</i>	\$9.00	\$7.50	\$7.50
<i>Royal Family</i>	\$9.00	\$7.50	\$7.50
<i>Big River</i>	\$12.00	\$10.50	\$10.50
<i>Bette And Boo</i>	\$9.00	\$7.50	\$7.50
Single Ticket Total	\$48.00	\$40.50	\$40.50
Season Ticket Cost	<b>\$40.00</b> (Save 17%)	<b>\$32.00</b> (Save 22%)	<b>\$30.00</b> (Save 27%)

*Lend Me A Tenor*, *Beauty and the Beast*, *The Royal Family* and *Big River* will be performed in Cowan Hall. *All My Sons* and *The Marriage of Bette and Boo* will be performed in the Campus Center Theatre.

I wish to order \_\_\_\_\_ Option #1 season tickets at \$40.00 each (save 17%) \$ \_\_\_\_\_  
 I wish to order \_\_\_\_\_ Option #2 season tickets at \$32.00 each (save 22%) \$ \_\_\_\_\_  
 I wish to order \_\_\_\_\_ Option #3 season tickets at \$30.00 each (save 27%) \$ \_\_\_\_\_  
 I wish to order \_\_\_\_\_ *Beauty and the Beast* tickets (optional) at \$3.50 each \$ \_\_\_\_\_

Enclose \$1.50 for Postage/Handling \$ 1.50  
 Please consider a tax-deductible contribution—any amount would be appreciated \$ \_\_\_\_\_  
 Total Enclosed \$ \_\_\_\_\_

### Season Ticket Availability Dates

Season tickets are available only for the dates listed below. Please circle desired date for each play and underline your second choice in case the first is not available. **Note:** Option #3, Opening Nite Club, must circle the 1st Wednesday for each play and the 1st Thursday for *Big River*. 1st Thursday subscribers should choose the 2nd Thursday for *Big River*.

	Wed.	Thurs.	Fri.	Sat.	Sun. Mat.
<i>Lend Me A Tenor</i> October	7	8 15	9 16	10 17	11
<i>All My Sons</i> January/February	27 3	28 4	29 5	30 6	31 7
<i>Royal Family</i> March	10	11	12	13	14
<i>Big River</i> April/May		29 6	30 7	1 8	2
<i>Bette and Boo</i> May/June	26 2	27 3	28 4	29 5	30 6

**Special Children's Theatre:** As a bonus to subscribers, you may order your general admission tickets to *Beauty and the Beast* along with your season tickets at \$1.00 off the normal price. Please circle your desired performance below:

Fri. 11/20 7:30 p.m.	Sat. 11/21 10:30 a.m.	Sat. 11/21 1:30 p.m.	Sun. 11/22 1:30 p.m.
-------------------------	--------------------------	-------------------------	-------------------------

Make check payable to Otterbein College Theatre or charge to:

MasterCard # \_\_\_\_\_ or Visa # \_\_\_\_\_ Exp. Date \_\_\_\_\_  
 Name \_\_\_\_\_ Signature (for charge card) \_\_\_\_\_  
 Street \_\_\_\_\_ City \_\_\_\_\_ State \_\_\_\_\_ Zip Code \_\_\_\_\_  
 Phone (home) \_\_\_\_\_ (work) \_\_\_\_\_  
 I am a new subscriber ☐ Yes ☐ No I am a former summer/winter season subscriber (circle one or both).

**All sales are final--  
ticket requests will be  
filled in the order they  
arrive at the box office.**

**Your tickets will be  
mailed to you the week  
of September 21, 1992**